



INSTRUCTIONS

Kit Number:

90500289 REV A

Kit Description:

The Solo Seat Installation Kit contains all fasteners and hardware required to install a solo seat to the vehicle. For complete seat replacement, specific Solo Seat and Medallion Kit selections are required in addition to this hardware kit.

Installation Instructions:

1. Install medallion kit (see additional kit requirements) if needed
 2. Install passenger seat (see additional kit requirements) if needed
 3. Install seat grab rail kit (PN # 90800086) if needed
- Note: Passenger seat and Seat Grab Rail can NOT be installed together.*
4. Install seat onto bike ensuring:
 - a. The male front tab on solo seat engages properly on female frame tab
 - b. The two side brackets on the seat engage properly in frame openings
 5. Align holes in frame to seat bracket and install fastener (#2) and washer (#1). Torque 74-88 lbs. inch
 6. See passenger seat install or seat grab rail install for additional instructions

Warning: After installing seat, pull upward on seat to ensure the seat is secured in position. If the seat is not properly secured, the seat shift can cause loss of control, which could result in serious injury.

Exploded View of Assembly:

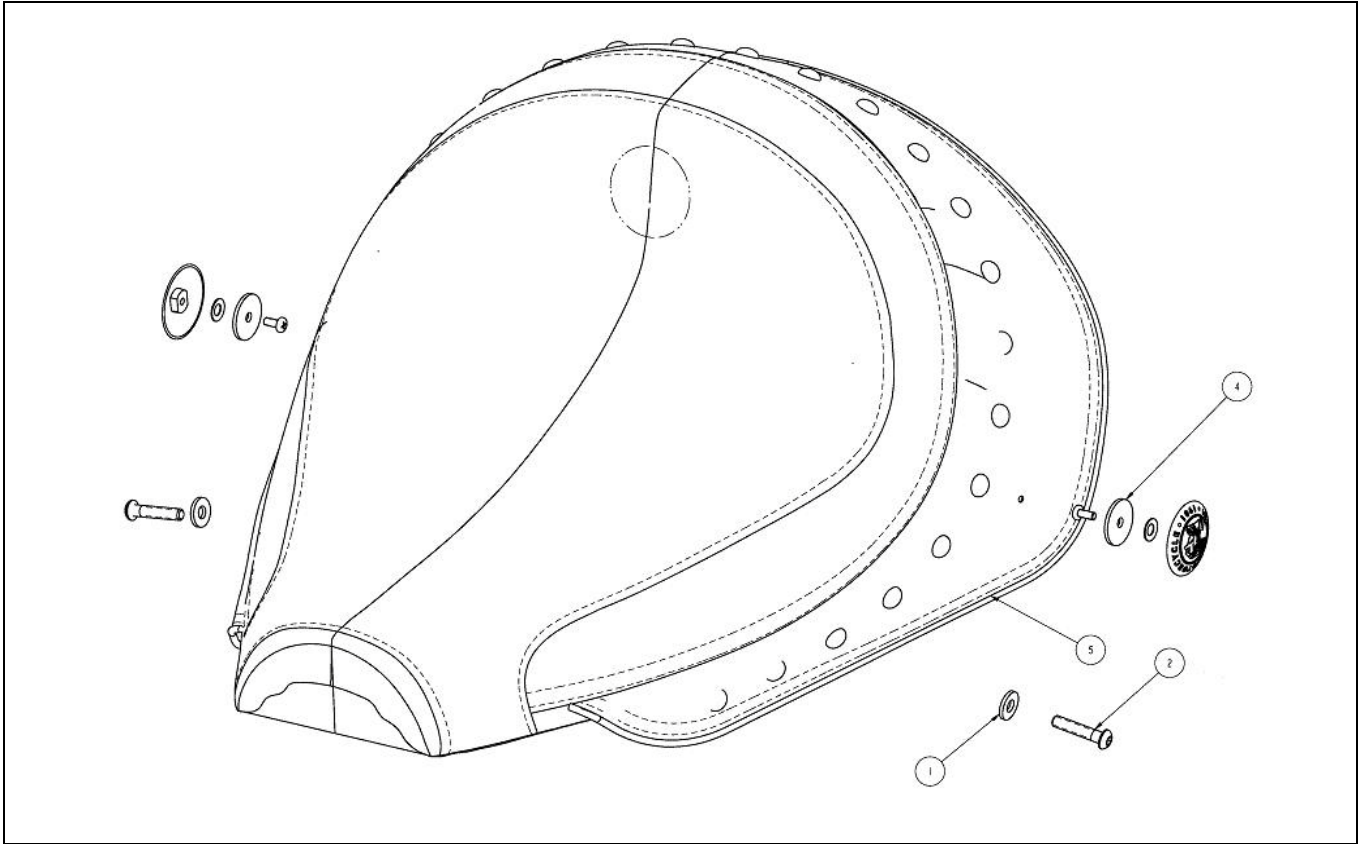

Kit Bill of Material:

ITEM	PART NUMBER	PART DESCRIPTION	QTY
1	70496920	1/4" Flat Washer, Steel, Chrome	2
2	70196384	1/4-20 X 1.25", Button Head Cap Screw, Chrome	2
	90800099	Solo Seat Installation Instruction Sheet	1

Additional Kit Requirements:

ITEM	PART NUMBER	PART DESCRIPTION	QTY
4	90500330	CONCHO INSTALLATION KIT (See Kit for Selections)	1
	Select From Below	SOLO SEAT	
5	51600018	Black, Solo Seat, no Fringe	1
5	51600019	Black, Solo Seat, with Fringe	1
5	51600020	Tan, Solo Seat, no Fringe	1
5	51600021	Tan, Solo Seat, with Fringe	1
5	51600022	Red, Solo Seat, no Fringe	1
5	51600023	Red, Solo Seat, with Fringe	1
5	51600083	Distressed Tan, Solo Seat, no Fringe	1
5	51600084	Tan Suede, Solo Seat, no Fringe	1
5	51600009	Red, Solo Seat, Red&White Fringe	1

Kit Retro-fit-ability to Existing Models:

Y: Directly Retro-fit-able

M: Retro-fit-able with some modification, see your local service provider for details

N: Not Retro-fit-able

MODEL YEAR	MODEL FAMILY							
	CHIEF	SCOUT	N/A	N/A	N/A	N/A	N/A	N/A
1998	N	N						
1999	N	N						
2000	N	N						
2001	N	N						
2002	N	N						
2003	M	N						
2004	M	N						
2009 +	Y	N						

Disclaimer:

To help maintain the value of your motorcycle and to keep from voiding your factory warranty, please remember that skilled technicians using equipment and methods recommended by IMC are best qualified to perform all major repairs and service including installation of Parts and Accessories. Your authorized Indian Motorcycle Dealer knows your motorcycle best and should be consulted for service and assistance.