



INSTRUCTIONS

Kit Number:

90500290 REV A

Kit Description:

The Dual Seat Installation Kit contains, only, all fasteners and hardware required to install a dual seat to the vehicle. For complete seat replacement, specific Dual Seat and Medallion Kit selections are required in addition to this hardware kit.

Installation Instructions:

1. Install medallion kit (see additional kit requirements) if needed
2. Install seat (#7) onto bike ensuring:
 - a. The male front tab on solo seat engages properly on female frame tab
 - b. The two side brackets on the seat engage properly in frame openings
3. Align holes in frame to seat bracket and install fastener (#4) and washer (#1). Torque 74-88 lbs. inch
4. Install rubber grommet (#2) between pillion bracket and rear fender to prevent paint damage
5. Install fastener (#3) with washer (#1) through rear seat bracket. Torque to 10-15 lbs. inch

Warning: *After installing seat, pull upward on seat to ensure the seat is secured in position. If the seat is not properly secured, the seat shift can cause loss of control, which could result in serious injury.*

Exploded View of Assembly:

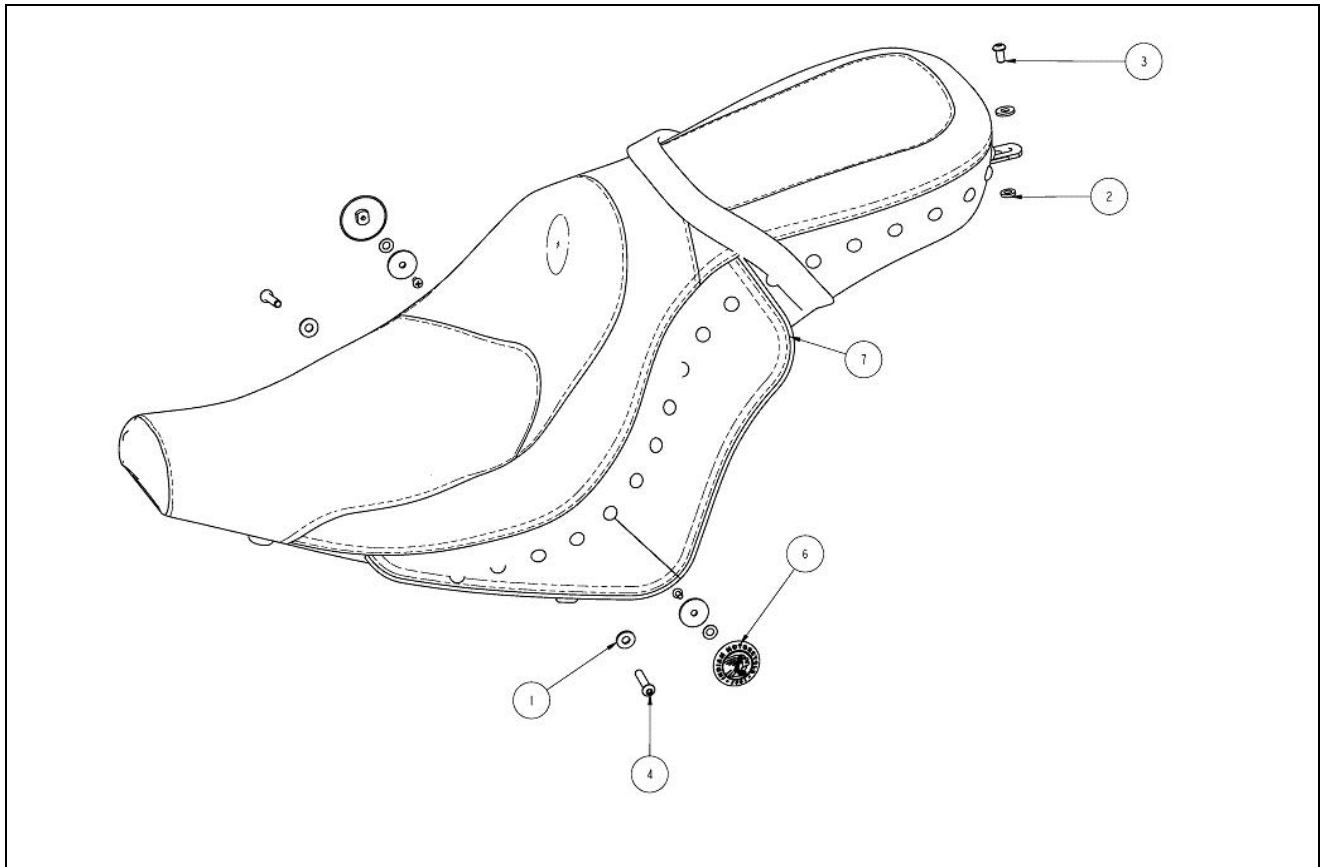

Kit Bill of Material:

ITEM	PART NUMBER	PART DESCRIPTION	QTY
1	70496920	1/4" Flat Washer, Steel, Chrome	3
2	70496383	1/2" OD Rubber Grommet	1
3	70100046	1/4-20 X .5", Button Head Cap Screw, Chrome	1
4	70196384	1/4-20 X 1.25", Button Head Cap Screw, Chrome	2
	90800122	Dual Seat Installation Instruction Sheet	1

Additional Kit Requirements:

ITEM	PART NUMBER	PART DESCRIPTION	QTY
6	90500330	CONCHO INSTALLATION KIT (See Kit for Selections)	1
	Select From Below	DUAL SEAT	
7	51600037	Black, Dual Seat, no Fringe	1
7	51600038	Black, Dual Seat, with Fringe	1
7	51600039	Tan, Dual Seat, no Fringe	1
7	51600040	Tan, Dual Seat, with Fringe	1
7	51600041	Red, Dual Seat, no Fringe	1

7	51600042	Red, Dual Seat, with Fringe	1
7	51600100	Distressed Tan, Dual Seat, no Fringe	1
7	51600086	Distressed Tan, Dual Seat, with Fringe	1

Kit Retro-fit-ability to Existing Models:

Y: Directly Retro-fit-able

M: Retro-fit-able with some modification, see your local service provider for details

N: Not Retro-fit-able

MODEL YEAR	MODEL FAMILY				
	CHIEF	SCOUT	N/A	N/A	N/A
1998	N	N			
1999	N	N			
2000	N	N			
2001	N	N			
2002	N	N			
2003	M	N			
2004	M	N			
2009 +	Y	N			

Disclaimer:

To help maintain the value of your motorcycle and to keep from voiding your factory warranty, please remember that skilled technicians using equipment and methods recommended by IMC are best qualified to perform all major repairs and service including installation of Parts and Accessories. Your authorized Indian Motorcycle Dealer knows your motorcycle best and should be consulted for service and assistance.