



# INSTRUCTIONS

**Applicable Kit Number/s:**

90500172 REV A

**Kit Description:**

This Chrome Front Caliper Kit comes complete with the items listed in the Bill of Material.

**Installation Instructions:****Removal**

1. Remove front fender (see service manual for instructions)
2. Remove banjo bolt( 5) and allow brake fluid to drain in suitable container
3. Discard two crush washers(6)and banjo bolt(5)
4. Remove two mounting fasteners(3) and discard
5. Remove caliper from rotor
6. Repeat for the opposite caliper

**Installation**

1. Install new polished caliper (2) and two new mounting fasteners (3)
2. Torque mounting fasteners to 36-44 lbs. ft
3. Install new banjo bolt (5) with two new crush washers (6) to brake line
4. Torque banjo bolt to 13-17 lbs. ft
5. Repeat for opposite caliper
6. Bleed calipers (per service manual instructions)
7. Install front fender (see service manual instructions)

**Exploded View of Assembly:**

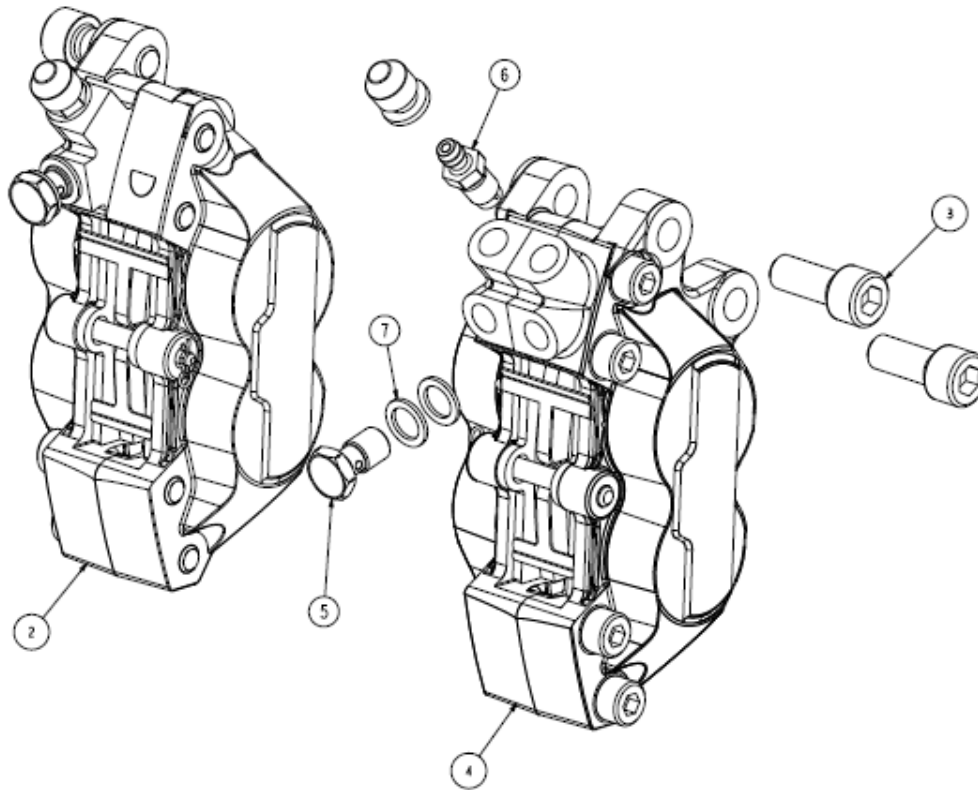

**Kit Bill of Material:**

ITEM	PART NUMBER	PART DESCRIPTION	QTY
1	90800065	INSTR, FRONT CALIPER, POLISHED	1
2	50250053	LH FRT CALIPER, POLISHED	1
3	70150129	M10 X 1.50 X 25 SHCS, 10.9, Z/C	4
4	50250011	RH FRT CALIPER, POLISHED	1
5	50250060	M10X1.0-17.5 BANJO BOLT, CHR	2
6	50250067	BLEEDER VALVE W/DUST CAP	2
7	50250109	M10 SEALING WSHR AL	4

**Additional Kit Requirements:**

ITEM	KIT NUMBER	KIT DESCRIPTION	QTY
1	XXXXXXXX1	Description of Required Kit 1	X
2	XXXXXXXX2	Description of Required Kit 2	X
3	XXXXXXXX3	Description of Required Kit 3	X

**Kit Retro-fit-ability to Existing Models:**

Y: Directly Retro-fit-able

M: Retro-fit-able with some modification, see your local service provider for details

N: Not Retro-fit-able

MODEL YEAR	MODEL FAMILY					
	CHIEF	SCOUT	N/A	N/A	N/A	N/A
1998	N	N				
1999	N	N				
2000	N	N				
2001	N	N				
2002	N	N				
2003	N	N				
2004	N	N				
2009 +	Y	N				

**Disclaimer:**

To help maintain the value of your motorcycle and to keep from voiding you factory warranty, please remember that skilled technicians using equipment and methods recommended by IMC are best qualified to perform all major repairs and service including installation of Parts and Accessories. Your authorized Indian Motorcycle Dealer knows your motorcycle best and should be consulted for service and assistance.